

TECHSPEC® 0.9X CobaltTL Telecentric Lens

#62-901



0.9X Magnification

TECHSPEC® CobaltTL Telecentric Lenses are designed for semiconductor and electronics inspection, measurement, and gauging applications. These telecentric lenses achieve high light throughput with industry leading low $f/\#$ s. Featuring less than 0.015° telecentricity and low 0.013% distortion, these lenses are ideal for image stitching applications. These 17.6mm diagonal sensor format lenses are compatible with the Sony IMX304 1.1" sensors and other similar format sensors such as the Sony IMX183. TECHSPEC® CobaltTL Telecentric Lenses produce unparalleled levels of contrast yielding maximum image quality with the highest degree of measurement accuracy. In-line versions provide the ability to rotate/reposition the inline illumination port to allow for maximum flexibility when machine building. TECHSPEC® CobaltTL Telecentric Lenses are compatible with high vibration environments and feature a removable recessed set screw for securely locking the iris in place.

Flange Distance (mm):	17.5
Coating:	425 - 675nm BBAR
Depth of Field (mm):	±1.17mm at f/10 (20% @ 20 lp/mm)

Optical

Horizontal Field of View, 1/2" Sensor:	8.89mm
Horizontal Field of View, 2/3" Sensor:	12.23mm
Horizontal Field of View, 1" Sensor:	14.4mm
Numerical Aperture NA, Object Side:	0.075
Horizontal Field of View, 1.1" Sensor:	15.65mm
Horizontal Field of View, 1/1.8" Sensor:	10.01mm
Typical Telecentricity @ 588nm (°):	<0.089
Typical Distortion @ 588nm (%):	<0.014
Primary Magnification PMAG:	0.9X
Maximum Sensor Format:	1.1"
Working Distance (mm):	111
Aperture (f/#):	f/6 - f/22
FOV @ Max Sensor Format, H x V (mm):	15.8 x 11.6
Lens Wavelength Range:	VIS

Mechanical

Length (mm):	199.80
Filter Thread:	M62 x 0.75 (Female)
Maximum Diameter (mm):	65.0
Weight (g):	853
Number of Elements (Groups):	10 (7)
Mount:	C-Mount

General

Stock No. of Mounting Clamp:	#56-025 Sold Separately
Note:	Lens will cover a 19mm diagonal sensor.
Type:	Telecentric Lens



#62-901, 0.9X CobaltTL Telecentric Lens, Distortion Plot

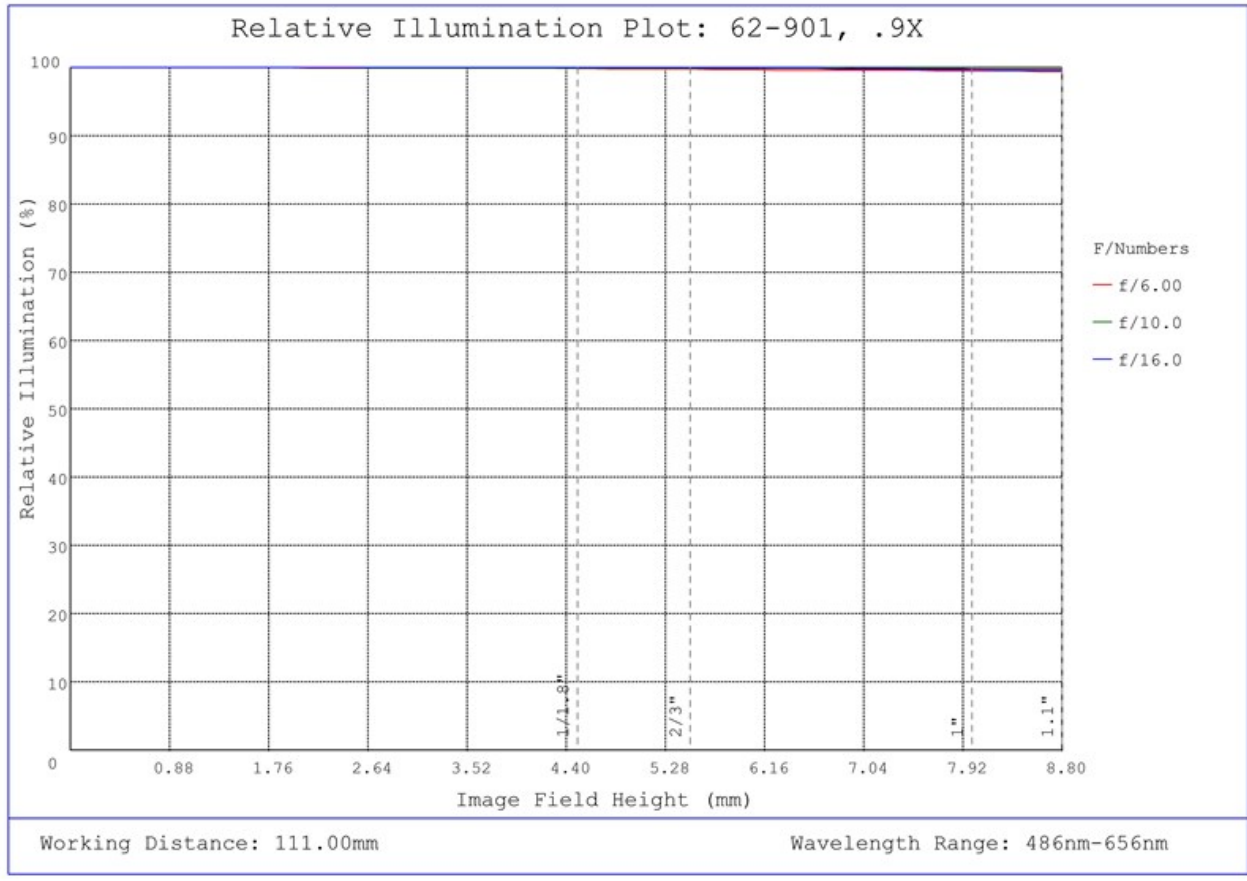

#62-901, 0.9X CobaltTL Telecentric Lens, Relative Illumination Plot

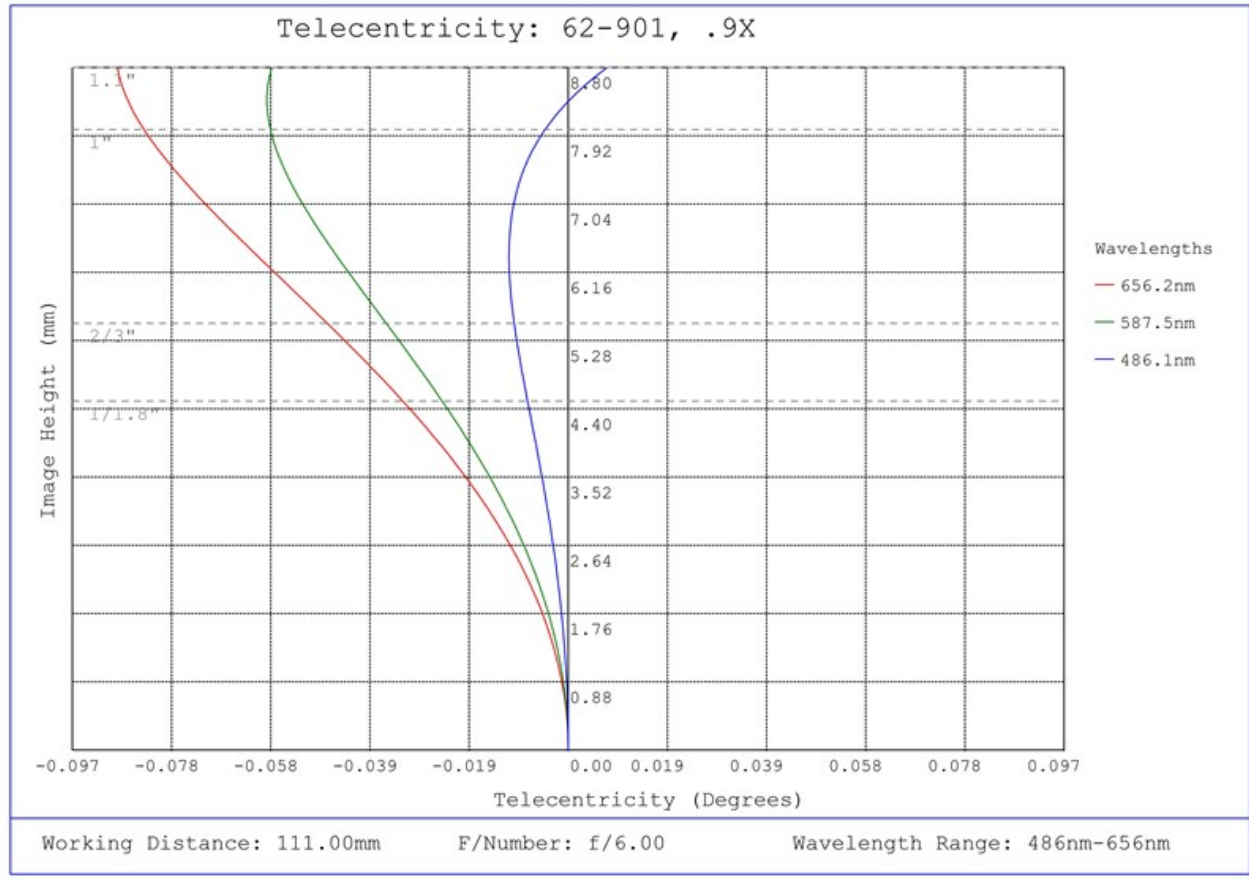

#62-901, 0.9X CobaltTL Telecentric Lens, Telecentricity Plot

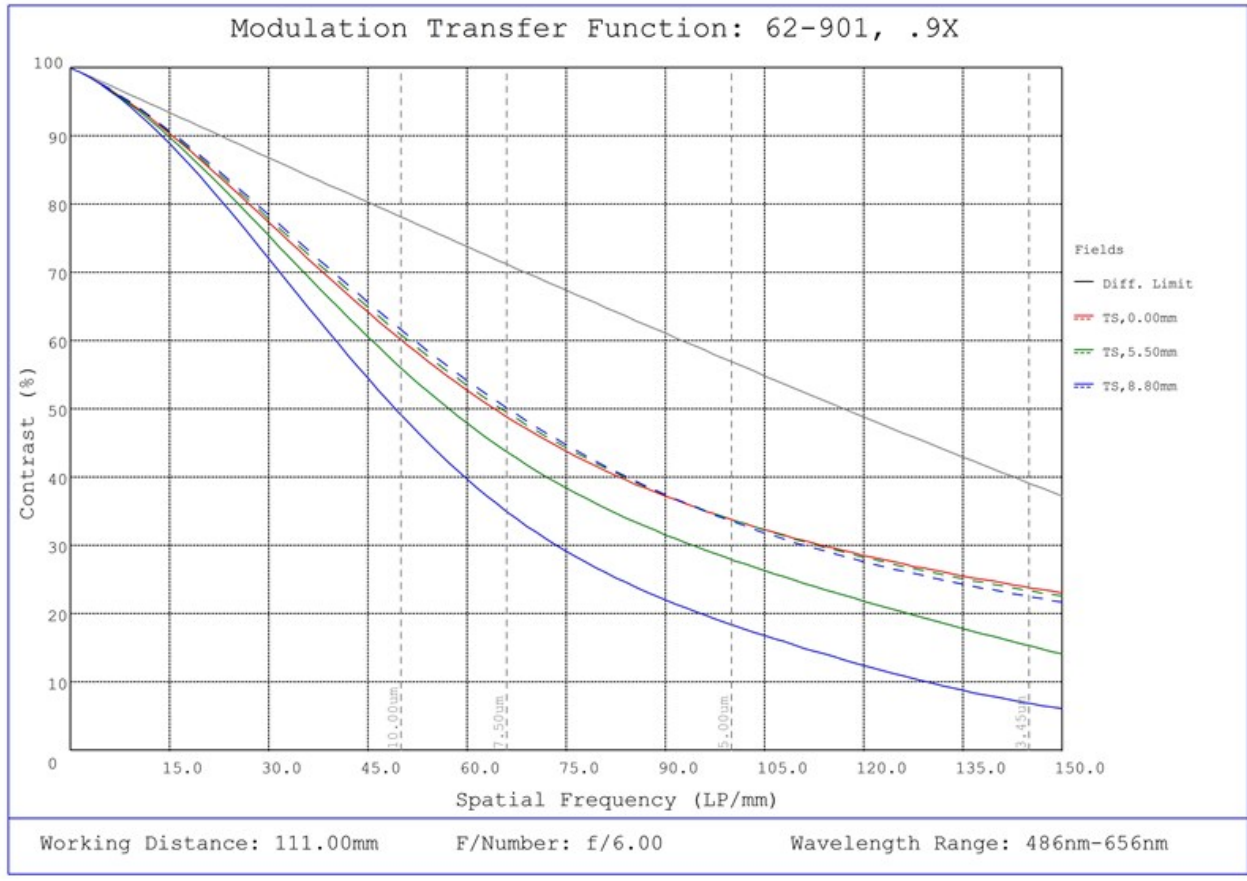

#62-901, 0.9X CobaltTL Telecentric Lens, Modulated Transfer Function (MTF) Plot, 111mm Working Distance, f6

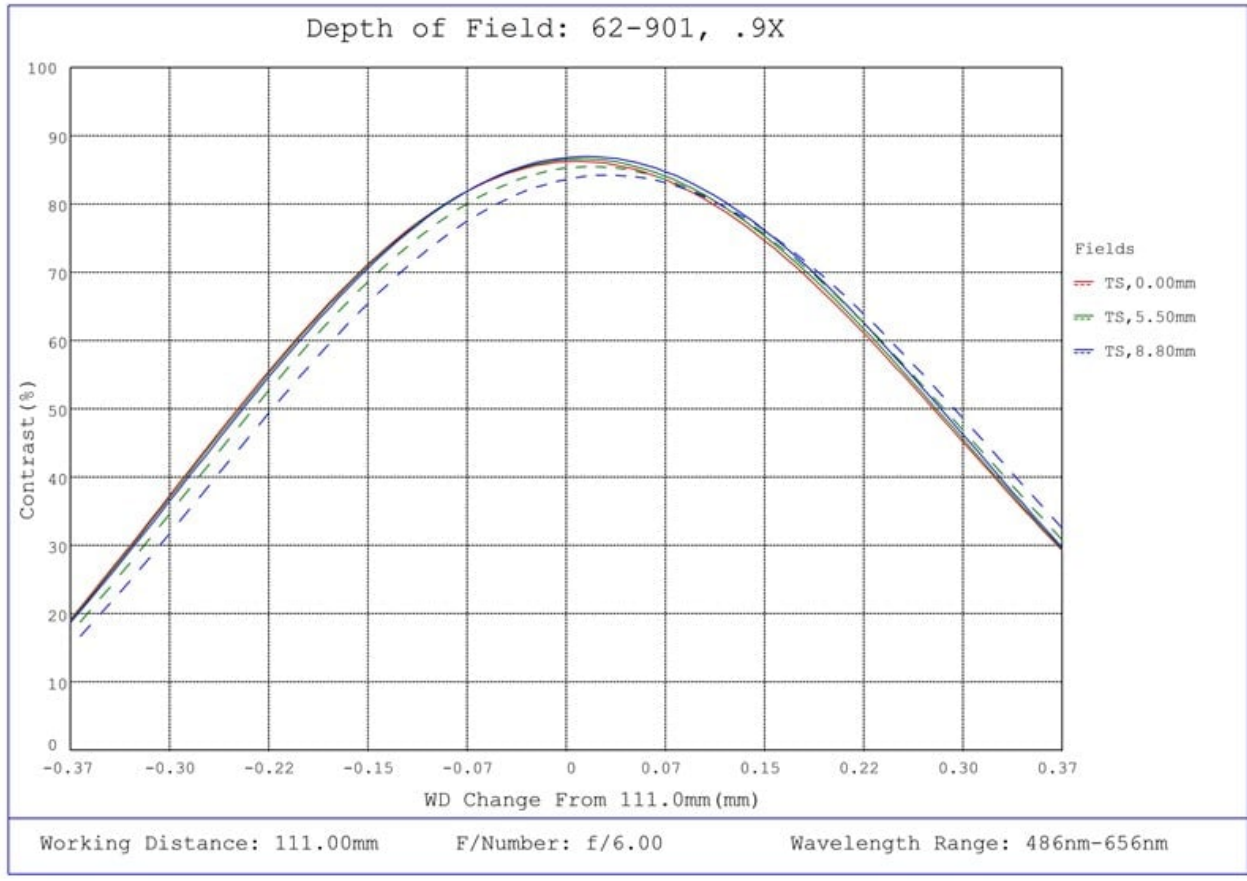

#62-901, 0.9X CobaltTL Telecentric Lens, Depth of Field Plot, 111mm Working Distance, f6

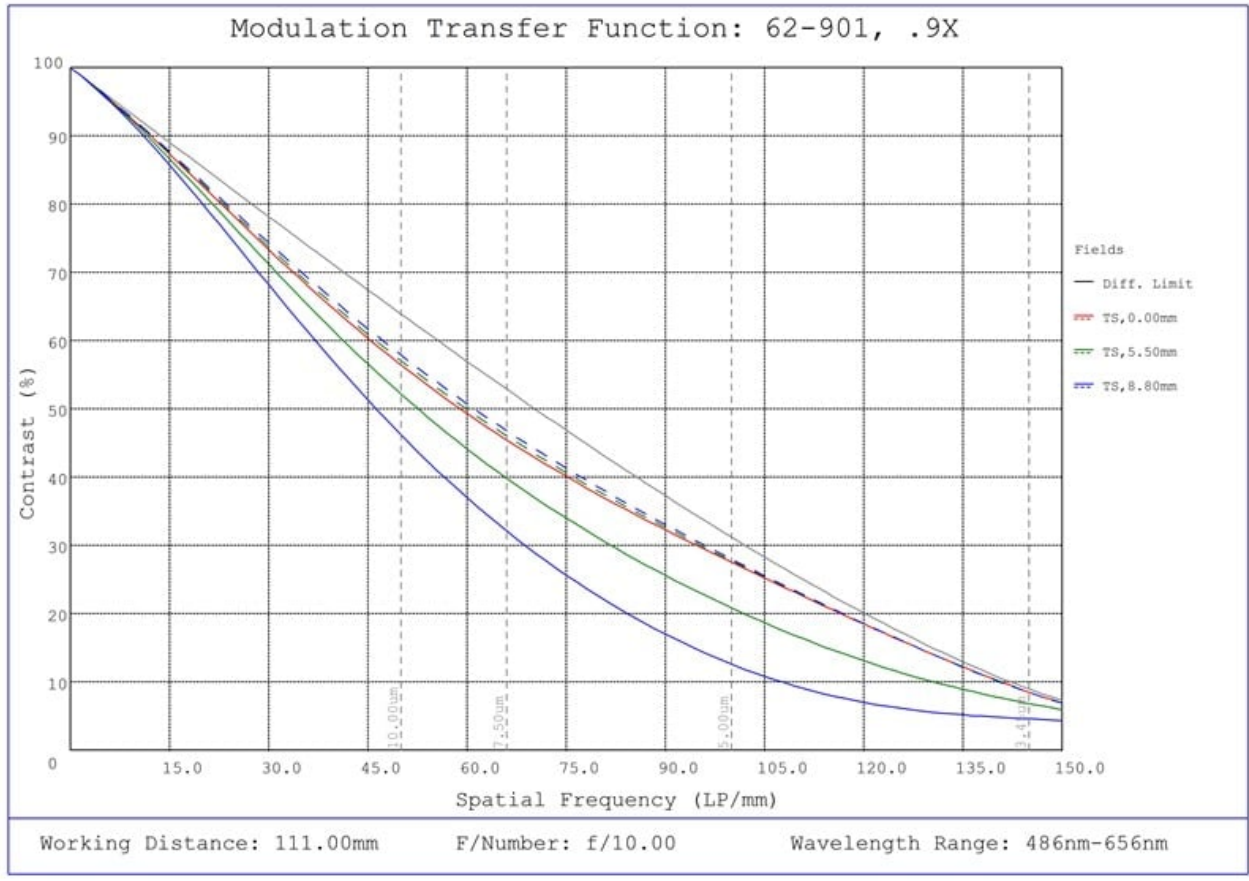

#62-901, 0.9X CobaltTL Telecentric Lens, Modulated Transfer Function (MTF) Plot, 111mm Working Distance, f10



#62-901, 0.9X CobaltTL Telecentric Lens, Depth of Field Plot, 111mm Working Distance, f10



September 08, 2023

To Whom It May Concern,

This document certifies that the product stated below has been reviewed as requested by Edmund Optics:

<i>Stock No.</i>	<i>Description</i>
62-901	0.9X CobaltTL Telecentric Lens

This item is EU RoHS (2011/65/EU) exempt based on **Exemption 6c**: Copper alloy containing up to 4% lead by weight.

This certification means that:

- EO's suppliers have confirmed the material composition of this product.
- EO has implemented rigorous procedures to document this compliance.
- The information provided may, or may not, be based upon actual test data, or on information from our Vendors, Raw Material Suppliers or Subcontractors.

Jay Budd, Director of Corporate Compliance
September 08, 2023Edmund Optics Inc. - 101 E Gloucester Pike, Barrington, NJ 08007 | 1-800-363-1992 | Compliance@edmundoptics.com

September 08, 2023

<i>Stock No.</i>	<i>Description</i>
62-901	0.9X CobaltTL Telecentric Lens

Edmund Optics certifies that all articles included in this shipment are in compliance with the terms and conditions of this order. The company also certifies that the articles included in this shipment are in accordance to all agreed upon specifications and quality assurance provisions. Please call 1-800-363-1992 should any questions arise from this shipment.



Jeff Harvey- EVP of Operations

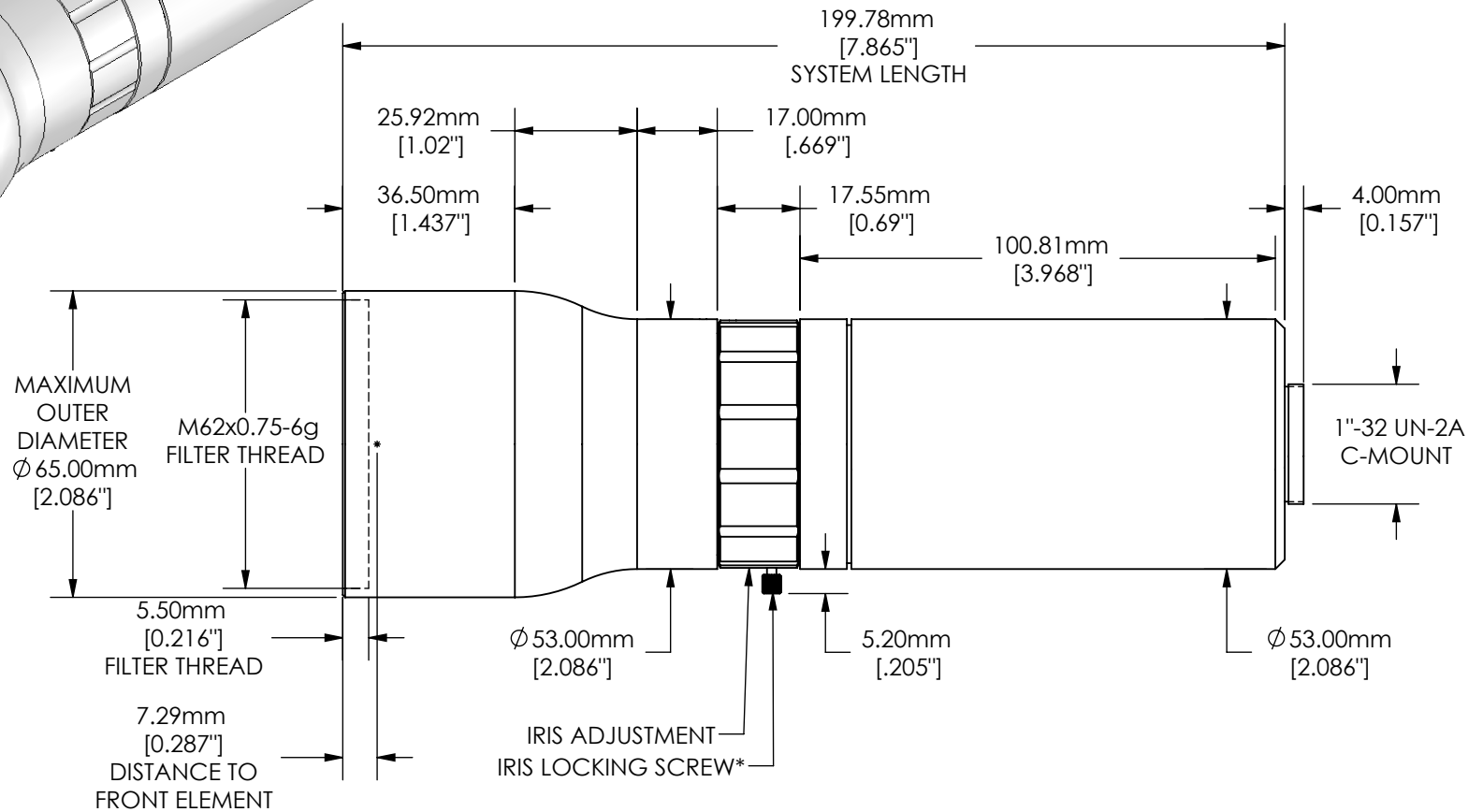
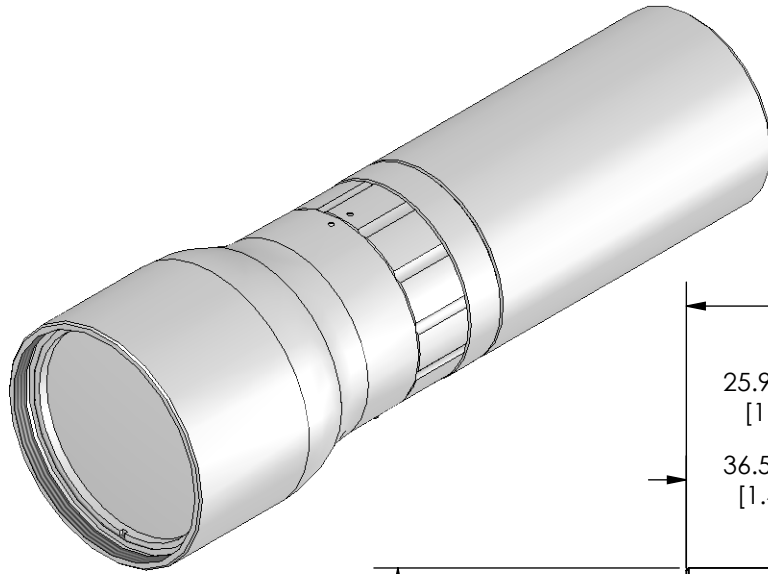

* ALSO INCLUDES RECESSED SET SCREW OPTION

**FOR INFORMATION ONLY:
DO NOT MANUFACTURE
PARTS TO THIS DRAWING**

SPECIFICATIONS SUBJECT TO CHANGE WITHOUT NOTICE. DIMENSIONS ARE FOR REFERENCE ONLY. FOR DETAILED SPECIFICATIONS, PLEASE REFER TO THE SPEC SHEET.



TITLE	0.9X, 1" C-Mount PlatinumTL™ Telecentric Lens	
DWG NO	62901	
		SHEET 1 OF 1

Enable 3D View