



10 GIGAVISION GEN<i>i>CAM



sensor information

sensor	Sony IMX252
resolution	2048 × 1536 px
exposure time	0,001 ... 60000 ms
pixel size	3.45 × 3.45 µm
shutter type	Global shutter
sensor type	1/1.8" CMOS

acquisition formats

image formats, interface	Full Frame, 2048 × 1536 px, max. 216 fps
frame rate max.	Binning 2×2, 1024 × 768 px, max. 216 fps Binning 2×1, 1024 × 1536 px, max. 216 fps Binning 1×2, 2048 × 768 px, max. 215 fps
image formats, acquisition	Full Frame, 2048 × 1536 px, max. 216 fps
frame rate max. (Burst Mode)	
pixel formats	Mono8 Mono10 Mono12 Mono12 Packed

image preprocessing

analog controls	Gain (0 ... 48 dB) Offset (0 ... 255 LSB 12 Bit)
color models	Mono

interfaces and connectors

data interface	10 Gigabit Ethernet, Transfer rate 10000 Mbits/sec, Gigabit Ethernet, Transfer rate 1000 Mbits/sec, Fast Ethernet, Transfer rate 100 Mbits/sec, Connector: M12 / 8-pol x-coded (SACC-CI-M12FS-8CON-L180-10G)
process interface	M12 / 12 pins a-coded (SACC-CI-M12MS-12CON-L180)
power supply	via M12/12 pins a-coded

mechanical data

lens mount	C-mount
------------	---------

mechanical data

width	60 mm
height	60 mm
depth	99,7 mm
weight	≤ 485 g
material	aluminum

electrical data

voltage supply range +Vs	12 ... 24 V DC (external power supply)
power consumption	approx. 10,1 W @ 12 VDC and 216 fps

non-volatile memory

flash memory size	128 kB
-------------------	--------

environmental conditions

operating temperature	0 ... +65 ° @ T = measurement point
humidity	10 ... 90 % (non-condensing)
protection class	IP 40 IP 54 (with mounted tube and cable) IP 65 (with mounted tube and cable) IP 67 (with mounted tube and cable)

digital I/Os

lines	2 input lines 4 output lines with pulse width modulation (PWM) (max. 48 V / max. 2,5 A) RS232
-------	---

conformity

conformity	CE RoHS
------------	------------

VLXT-31M.I

Gigabit Ethernet, 3,1 Megapixel, Monochrome

Article number: 11192941

dimension drawing

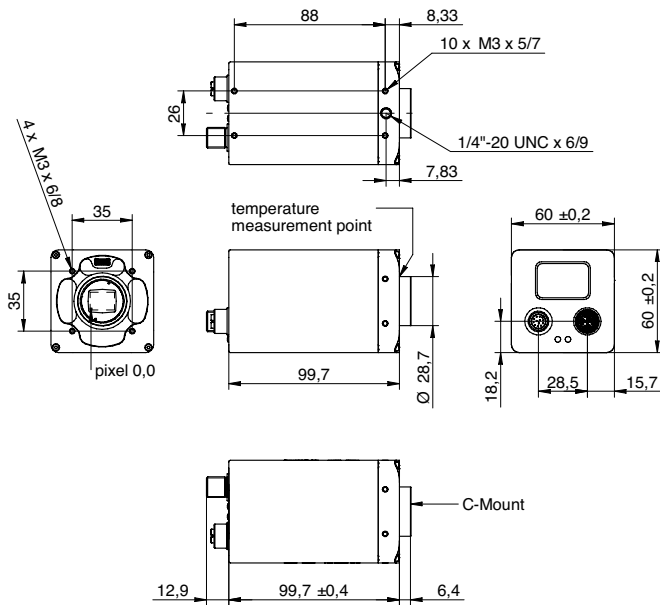

schematic diagram

Optional accessories for protection class IP65/67:

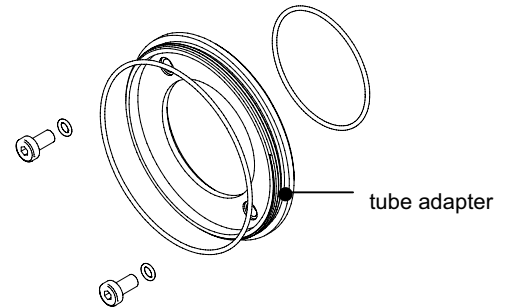

tube adapter

- $\varnothing 49,5$ mm, hard-anodized, incl. sealing and screws (VCXG.I 11185373)
- $\varnothing 65$ mm, hard-anodized, incl. sealing and screws (VCXG.I 11185377; VLXT 11193125)

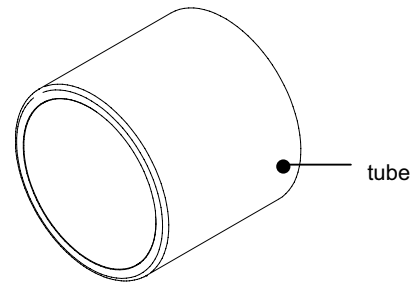

tube

- $\varnothing 49,5$ mm, length 44 mm, hard-anodized, cover glass PMMA (11185370)
- $\varnothing 65$ mm, length 58 mm, hard-anodized, cover glass PMMA (11185374)
- $\varnothing 49,5$ mm, length 44 mm, hard-anodized, tempered laminated safety glass (11195425)
- $\varnothing 65$ mm, length 58 mm, hard-anodized, tempered laminated safety glass (11195426)

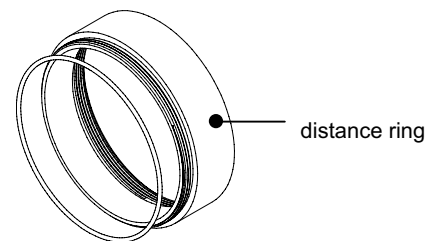

distance ring

- $\varnothing 49,5$ mm, length 12 mm, hard-anodized, incl. sealing (11185371)
- $\varnothing 49,5$ mm, length 6 mm, hard-anodized, incl. sealing (11185372)
- $\varnothing 65$ mm, length 12 mm, hard-anodized, incl. sealing (11185375)
- $\varnothing 65$ mm, length 6 mm, hard-anodized, incl. sealing (11185376)
- $\varnothing 65$ mm, length 36 mm, hard-anodized, incl. sealing (111988906)