



**10 GIGAVISION GEN<i>i>CAM**



sensor information	
sensor	Sony IMX255
resolution	4096 × 2160 px
exposure time	0,001 ... 60000 ms
pixel size	3.45 × 3.45 µm
shutter type	Global shutter
sensor type	1" CMOS
acquisition formats	
image formats, interface	Full Frame, 4096 × 2160 px, max. 95 fps
frame rate max.	Binning 2×2, 2048 × 1080 px, max. 184 fps Binning 2×1, 2048 × 2160 px, max. 95 fps Binning 1×2, 4096 × 1080 px, max. 95 fps
image formats, acquisition	Full Frame, 4096 × 2160 px, max. 95 fps
frame rate max. (Burst Mode)	
pixel formats	Mono8 Mono10 Mono12 Mono12 Packed
image preprocessing	
analog controls	Gain (0 ... 48 dB) Offset (0 ... 255 LSB 12 Bit)
color models	Mono
interfaces and connectors	
data interface	10 Gigabit Ethernet, Transfer rate 10000 Mbits/sec, Gigabit Ethernet, Transfer rate 1000 Mbits/sec, Fast Ethernet, Transfer rate 100 Mbits/sec, Connector: M12 / 8-pol x-coded (SACC-CI-M12FS-8CON-L180-10G)
process interface	M12 / 12 pins a-coded (SACC-CI-M12MS-12CON-L180)
power supply	via M12/12 pins a-coded
mechanical data	
lens mount	C-mount

mechanical data	
width	60 mm
height	60 mm
depth	99,7 mm
weight	≤ 485 g
material	aluminum
electrical data	
voltage supply range +Vs	12 ... 24 V DC (external power supply)
power consumption	approx. 10,5 W @ 12 VDC and 95 fps
non-volatile memory	
flash memory size	128 kB
environmental conditions	
operating temperature	0 ... +65 ° @ T = measurement point
humidity	10 ... 90 % (non-condensing)
protection class	IP 40 IP 54 (with mounted tube and cable) IP 65 (with mounted tube and cable) IP 67 (with mounted tube and cable)
digital I/Os	
lines	2 input lines 4 output lines with pulse width modulation (PWM) (max. 48 V / max. 2,5 A) RS232
conformity	
conformity	CE RoHS

The product characteristics and technical data provided do not express or imply any warranty. Technical modifications and errors reserved.

# VLXT-90M.I

Gigabit Ethernet, 8,8 Megapixel, Monochrome

Article number: 11192926

## dimension drawing

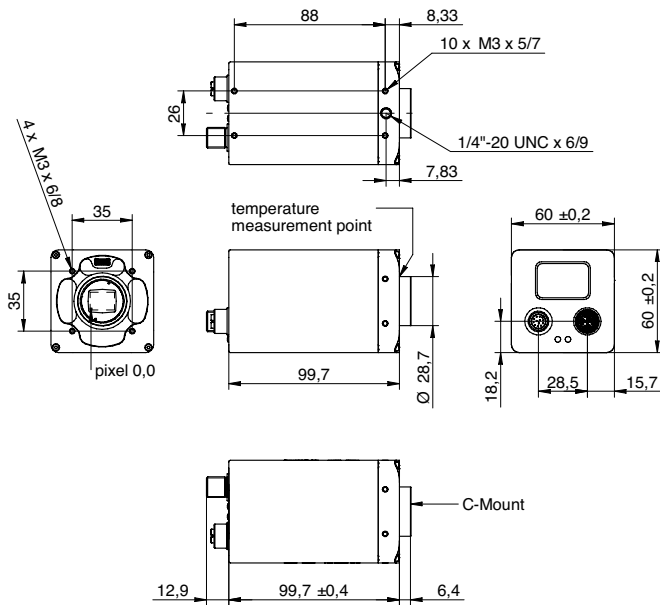

## schematic diagram

Optional accessories for protection class IP65/67:

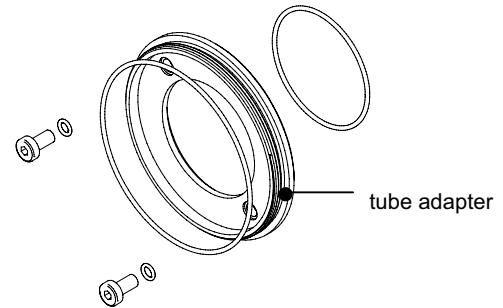

tube adapter

- $\varnothing 49,5$  mm, hard-anodized, incl. sealing and screws (VCXG.I 11185373)
- $\varnothing 65$  mm, hard-anodized, incl. sealing and screws (VCXG.I 11185377; VLXT 11193125)

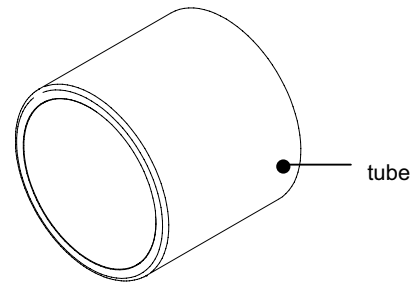

tube

- $\varnothing 49,5$  mm, length 44 mm, hard-anodized, cover glass PMMA (11185370)
- $\varnothing 65$  mm, length 58 mm, hard-anodized, cover glass PMMA (11185374)
- $\varnothing 49,5$  mm, length 44 mm, hard-anodized, tempered laminated safety glass (11195425)
- $\varnothing 65$  mm, length 58 mm, hard-anodized, tempered laminated safety glass (11195426)

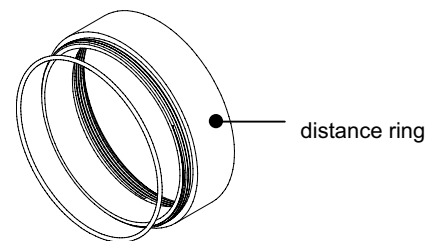

distance ring

- $\varnothing 49,5$  mm, length 12 mm, hard-anodized, incl. sealing (11185371)
- $\varnothing 49,5$  mm, length 6 mm, hard-anodized, incl. sealing (11185372)
- $\varnothing 65$  mm, length 12 mm, hard-anodized, incl. sealing (11185375)
- $\varnothing 65$  mm, length 6 mm, hard-anodized, incl. sealing (11185376)
- $\varnothing 65$  mm, length 36 mm, hard-anodized, incl. sealing (111988906)